

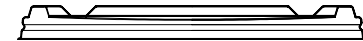

12-oz. DIP TRAY

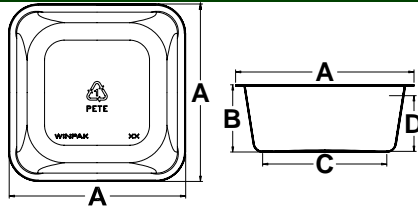

Product Description	12-oz. DIP TRAY		12-oz. DIP TRAY OVERCAP
Material	APET	 SIDE VIEW  BOTTOM VIEW	RPET
Colors	Clear		Clear
Rim Dimension (A) inches (mm)	4.75 (121)		4.89 (124)
Height (B) inches (mm)	1.80 (46)		0.47 (12)
Bottom Dimension (C) inches (mm)	3.75 (95)		4.75 (121)
Capacity (Water) fl. oz. (ml)	12.00 (354)		n/a
Labeling Capability	Yes		Yes
Rim Style	Flat		n/a
Case Quantity	1,200		1,200
Case Weight lbs. (kg)	27.0 (12.2)		24.0 (10.9)
Case Cube ft ³ (m ³)	3.4 (0.10)	3.4 (0.10)	

Call for stock color(s), availability, and non-stock cup color minimums.
 All values are nominal and do not include standard manufacturing tolerances.
 Nominal container capacity is from the fill line. Shown as (D) on container drawing.
 All sales are subject to Winpak's general terms and conditions.

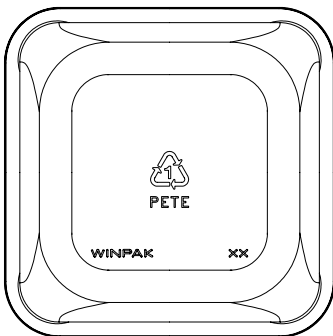
6-PACK TRAY

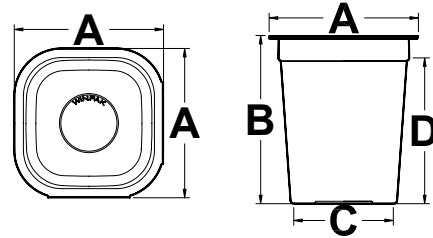

Product Description	6-PACK TRAY 2 x 3 MATRIX
Material	High Impact Polystyrene
Colors	White
Rim Dimension (A) (Each Cup) inches (mm)	2.45 (62)
Height (B) (Each Cup) inches (mm)	2.76 (70)
Bottom Dim. (C) (Each Cup) inches (mm)	1.74 (44)
Capacity (Water) (Each Cup) fl. oz. (ml)	4.33 (128) 125 grams (Yogurt)
Labeling Capability	Yes
Rim Style	Flat
Case Quantity	320
Case Weight lbs. (kg)	26.5 (12.0)
Case Cube ft³ (m³)	3.5 (0.10)

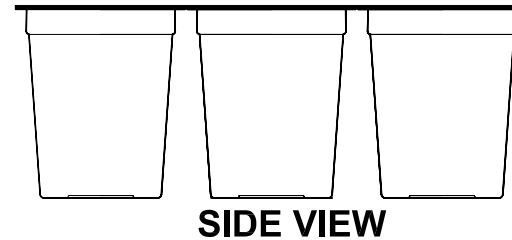

SIDE VIEW

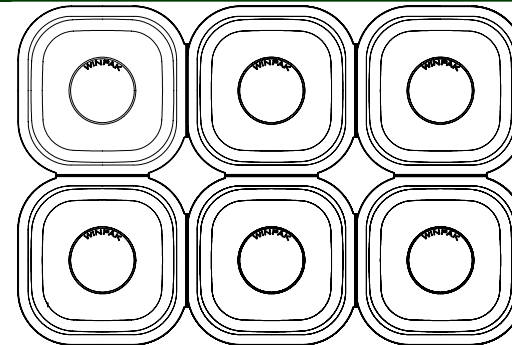

BOTTOM VIEW

Call for stock color(s), availability, and non-stock cup color minimums.
 All values are nominal and do not include standard manufacturing tolerances.
 Nominal container capacity is from the fill line. Shown as (D) on container drawing.
 All sales are subject to Winpak's general terms and conditions.

SINGLE AND DOUBLE POCKET TRAYS

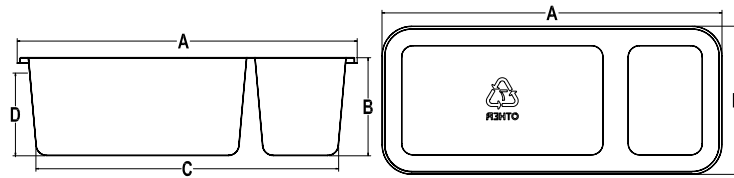
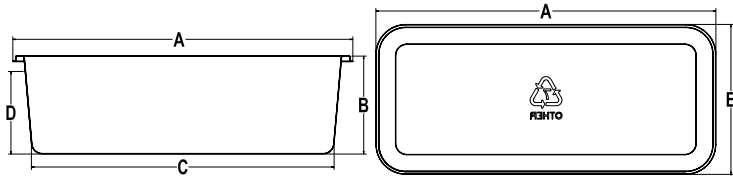

Product Description	SINGLE POCKET TRAY
Material	PS/EVOH/PE Barrier
Colors	Translucent, White
Tray Length (A) inches (mm)	5.86 (149)
Height (B) inches (mm)	1.44 (36)
Bottom Dia. (C) inches (mm)	5.21 (132)
Tray Width (E) inches (mm)	2.58 (66)
Capacity (Water) fl. oz. (ml)	7.1 (209)
Printing Capability	No
Rim Style	Flat
Case Quantity	1,000
Case Weight lbs. (kg)	25.0 (11.3)
Case Cube ft ³ (m ³)	3.5 (0.10)

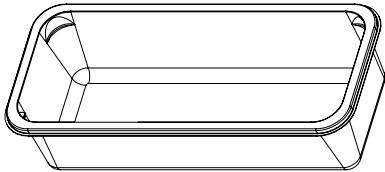

Product Description	DOUBLE POCKET TRAY
Material	PS/EVOH/PE Barrier
Colors	Translucent, White
Tray Length (A) inches (mm)	5.86 (149)
Height (B) inches (mm)	1.69 (43)
Bottom Dia. (C) inches (mm)	5.17 (131)
Tray Width (E) inches (mm)	2.58 (66)
Capacity (Water) fl. oz. (ml)	Small Pocket = 1.9 (57) Large Pocket = 4.8 (142) Total = 6.7 (199)
Printing Capability	No
Rim Style	Flat
Case Quantity	1,000
Case Weight lbs. (kg)	25.0 (11.3)
Case Cube ft ³ (m ³)	3.5 (0.10)

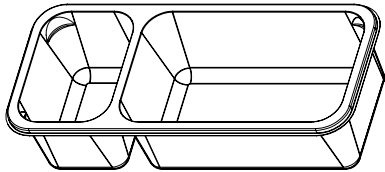

Call for stock color(s), availability, and non-stock cup color minimums.
 All values are nominal and do not include standard manufacturing tolerances.
 Nominal container capacity is from the fill line. Shown as (D) on container drawing.
 All sales are subject to Winpak's general terms and conditions.