

# FCA 160/120

Automatic Double-Clipper



innovative · reliable · leading

**poly-clip**<sup>®</sup>  
SYSTEM

# FCA 160/120

## FCA 160

For the 38 – 160 mm calibre range at up to 160 cycles per minute

## FCA 120

For the 24 – 120 mm calibre range at more than 200 cycles per minute

- Automatic, self-monitoring processes for maximum productivity
- Voiding separator and clip shape optimised for short sausage shoulders and more slices per sausage
- Central lubrication for maximum reliability and service life



FCA 160 – powerful machine for large calibres

## Applications

### FCA 160

The FCA 160 offers unrivalled versatility in an automatic clipper. It closes all fibrous and collagen casings up to 120 mm (depending on the material thickness), plastic casings up to 160 mm. The automatic double-clipper closes the R-ID clip sizes M, L and XL.

### FCA 120

The FCA 120 is characterised by a maximum speed at more than 200 cycles. It closes all fibrous and collagen casings up to 65 mm and plastic casings up to 120 mm. Maximum flexibility is achieved by the use of the R-ID clip sizes S and M.

## Advantages

- Automatic self-regulating process for maximum productivity
- Size of the voiding separator and setting of the clip pressure under servo control, can be saved as product parameters
- Incorrect settings are avoided by detection of the clip size and die
- R-ID clip – tighter clip closure, even up to bacteria-proof depending on the casing
- Uniform pleating and clean sausage tails due to the linear vertical voiding separator

- Robustness and long service life guaranteed by use of high-tech materials
- Infinitely adjustable speed plus continuous mode for maximum product versatility
- Simple machine operation with SAFETY TOUCH, break-proof, large and easy to clean
- SAFETY TOUCH – product parameters can be recalled from the programme memory
- Change of clip spacing quickly without tools and of spreading with just a few hand grips
- Safety by two-handed triggering of first clip
- Electronic hand-wheel for adjustments and setting parameters
- Product true to the calibre by adjustable conveyor speed
- Air-free slack filling of moulded

products by overspreading, total spreading up to 110 or 80 mm

- Simple ergonomic handling with the pneumatic swing-off and swing-on assistance
- Easy to manoeuvre with integral front wheel and retractable steering bar
- Completely sealed switchbox
- Low noise level
- Smooth surfaces make for easy cleaning
- Stainless steel provides resistance to aggressive cleaning solution
- Optimum accessibility for maintenance afforded by swing-off outer covers

Vertical linear voiding separator means short sausage shoulders with clean ends



Overspreading for air-free slack filling of moulded products



## Optional equipment

- Automatic looper GSA 20, loop on the left or on the right
- Spreading and overspreading servo-assisted
- Swivelling twin turret with foldable bar, casing change without swing-out of the clip head
- Easy handling due to semi-automatic clip guidance
- Auto-Stop System clip – sensor monitoring the end of clip supply on the reel
- Sensors for loops and casing end
- Pneumatic dry sausage brake, movable or fixed, can be set with servo assistance and retrieved as product parameter
- Automatic casing brake holder – Automatic Brake System
- Length portioning by means of optical scanning
- String dispenser for rings
- Registration control for centred printing format
- Filler coupling with ball joint
- Conveyor and roller conveyor, including extension, variants to suit product
- Single clip feature
- Clip coding
- Water-trickle application for casings, spray system for films
- Net applicator
- Central lubrication, machine cycle-dependent, for maximum reliability and service life

The FCA series with smooth surfaces of stainless steel for ease of cleaning



FCA 120 – the specialist machine for high speed production of calibres up to 120 mm

### FCA 120 extra

- Discharge tray with guard

### Function and operation

The automatic double clipper is connected mechanically and synchronized electrically to a filling machine. The portions are fed in precisely to the nearest gram and closed by a clip. The double-clipper's PC 100 controller allows a very fast and accurate signal processing and an improved fault diagnosis. It provides direct and unambiguous indication of defects or failures at the SAFETY TOUCH. Software data can be conveniently updated through the USB interface and operating data can be read via the WS-Food Standard's interface. A thorough process monitoring is guaranteed by the high degree of automation of the FCA. If there are deviations from the product programmes' set of parameters stored in the SAFETY TOUCH, the control system corrects automatically or a message is displayed. The operator is guided intuitively through the flat menu structure with informative icons. Operator, set-up and service levels are clearly separated and password protected. The automated operation offers the greatest product safety and maximum efficiency.

### Combinability

**AHL models and TLS** – automatic stick loading of looped products  
**ES 5000** – labelling system for marking and traceability

### Clip System Solutions

The complete system of clipping machine, clips and loops from one source ensures efficient, trouble-free production. The original clips from Poly-clip System guarantee top quality. The manufacture is subject to strictest quality standards, is certified to ISO 22000:2005 and ISO 9001:2008 and tuned precisely to the production process. The patented, food-proof, safety coating using Poly-clip SAFE-COAT technology, certified by the SGS INSTITUT FRESENIUS organization, ensures trouble-free production and a no-worry product warranty. Poly-clip System is the world's leading provider of Clip System Solutions.

# FCA 160/120

Dimensions (in mm)

Technical data

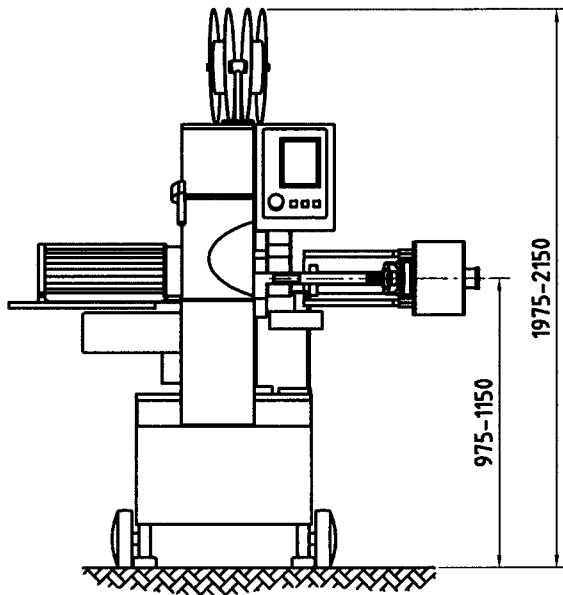

Front view

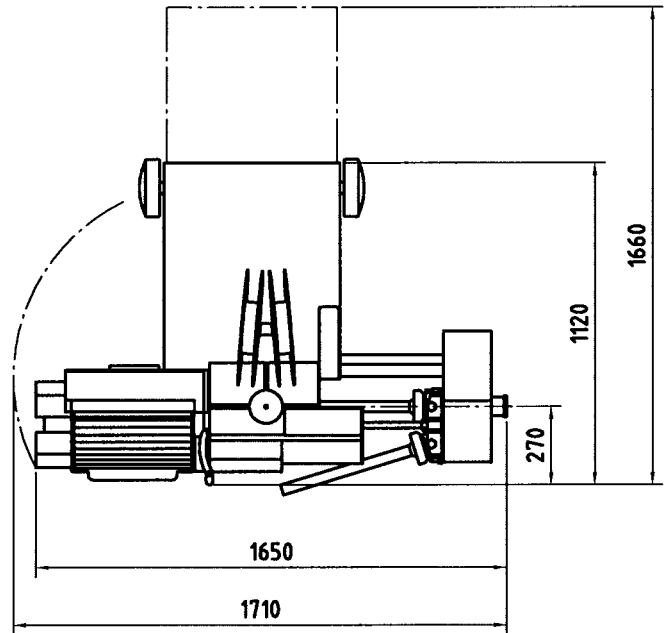

Top view

	FCA 160	FCA 120
Width:	1,650-1,710 mm	1,650-1,710 mm
Depth:	1,120-1,660 mm	1,120-1,660 mm
Height:	1,975-2,150 mm	1,975-2,150 mm
Weight:	610 kg	610 kg
Three-phase current connection:	200-230 VAC, 380-460 VAC, 50/60 Hz	
Power input:	4 kW	4 kW
Fuse connection:	16 A	16 A
Compressed air:	5-7 bar/0.5-0.7 MPa	5-7 bar/0.5-0.7 MPa
Air consumption:	1.6 NL/cycle	1.6 NL/cycle
R-ID Clip:	M, L, XL	S, M
Spreading:	26, 30, 36, 44 mm	18, 26, 30 mm
Incl. overspreading up to:	110 mm	80 mm

FCA 160/120-GB-04/13-HA Subject to technical modifications.

